



Social Safeguards Due Diligence Report

June 2022

India: Kolkata Environmental Improvement Investment Program-Tranche 3

Subproject : SD30/2017-18: Construction of 23 MLD Sewage Treatment Plant at Rajpur – Sonarpur, Rania (KEIIP/NCB/TR-3/SD 30R/2020-21)

Prepared by The Kolkata Municipal Corporation (KMC), Kolkata for the Asian Development Bank

This social safeguards due diligence report is a document of the borrower. The views expressed herein do not necessarily represent those of ADB's Board of Directors, Management, or staff, and may be preliminary in nature.

In preparing any country program or strategy, financing any project, or by making any designation of or reference to a particular territory or geographic area in this document, the Asian Development Bank does not intend to make any judgments as to the legal or other status of any territory or area.

Asian Development Bank

Land Acquisition and Resettlement Due Diligence Report

Updated report
Project number: 42266-026
March 2022

SFG Log 5066

IND: Kolkata Environmental Improvement Investment Program (Tranche 3)

Package No. SD30/2017-18: Construction of 23 MLD Sewage Treatment Plant at Rajpur – Sonarpur, Rania (KEIIP/NCB/TR-3/SD 30R/2020-21)

Prepared by Kolkata Municipal Corporation, Government of West Bengal for the Asian Development Bank.

ABBREVIATIONS

ADB	- Asian Development Bank
DDR	- due diligence report
DWF	- dry weather flow
KEIP	- Kolkata Environmental Improvement Project
KEIIP	- Kolkata Environmental Improvement Investment Program
KMC	- Kolkata Municipal Corporation
NOC	- no objection certificate
PMU	- program management unit
S&D	- sewerage and drainage
STP	- sewage treatment plant
WBSETCL	- West Bengal State Electricity Transmission Company Limited

NOTE

In this report, "\$" refers to United States dollars.

This due diligence report is a document of the borrower. The views expressed herein do not necessarily represent those of ADB's Board of Directors, management, or staff, and may be preliminary in nature. Your attention is directed to the "terms of use" section of this website.

In preparing any country program or strategy, financing any project, or by making any designation of or reference to a particular territory or geographic area in this document, the Asian Development Bank does not intend to make any judgments as to the legal or other status of any territory or area.

CONTENT

CURRENCY EQUIVALENTS.....	Error! Bookmark not defined.
ABBREVIATIONS.....	4
I. INTRODUCTION	6
A. Background	6
B. Scope of this Report	2
II. SUBPROJECT DESCRIPTION	3
III. FIELD WORK AND PUBLIC CONSULTATION	4
A. Outline of Field Work	4
B. Public Consultation	4
IV. LAND AVAILABILITY	6
V. CONCLUSION.....	8
A. Summary and Conclusion.....	8
PHOTO GALLERY - JIADAGOTE SEWAGE TREATMENT PLANT.....	9

TABLES

Table 1: Sewerage and Drainage Packages under Tranche 3.....	Error! Bookmark not defined.
Table 2: Planned Plant Capacity for Sewage Treatment Plant at Rajpur Sonarpur.....	3
Table 3: Influent Characteristics for Sewage Treatment Plant at Rajpur Sonarpur Municipality ...	3
Table 4: Summary of Community Consultation.....	5
Table 5: Details of Proposed Land of Rania	6
Table 6: Details of Dry Weather Flow Pipelines and Effluent Discharge Pipelines	6

FIGURES

Figure 1: Google Earth Map of Subproject Area	7
---	---

APPENDIXES

Appendix 1: Participants List of Community Consultation	
Appendix 2: Details of Proposed Land of Rania	
Appendix 3: Request letter for transfer/hand over of vested land to Kolkata Municipal Corporation for development work	
Appendix 4: Land Transfer process order copy from Office of the Block Land and Land Reforms Officer (BLRO) (Writ of Possession)	
Appendix 5: no objection certificate from Rajpur - Sonarpur Municipality	

I. INTRODUCTION

A. Background

1. The city of Kolkata is the seventh largest metropolis in India and had 4.5 million residents in 2011. It is the largest city in the state of West Bengal and has been the biggest contributor to West Bengal's gross state domestic product. The continuous improvement in the city's urban environment is necessary to increase labor productivity through better health status of the urban population, especially when it has been experiencing lower population growth. There have been, however, geographical disparities in access and quality of the water supply and sewerage services, because the Kolkata Municipal Corporation (KMC), an urban local body with a mandate to provide these services under the KMC Act of 1980, has an aging water supply system, and has inadequate sewer coverage in the city's peripheral areas¹. The Asian Development Bank (ADB) loans have assisted KMC in the expansion of the sewerage coverage through the Kolkata Environmental Improvement Project² (KEIP) since 2000. The Kolkata Environmental Improvement Investment Program³ (KEIIP) will help KMC not only to continue sewer network expansion and treatment on a larger scale but also gradually improve efficiency in water supply operations, which will enable KMC to generate operating surplus for capital investment in water supply and sewerage.

2. On 26 September 2013, ADB approved the provision of loans under a multi-tranche financing facility (MFF) for KEIIP for an aggregate amount not exceeding \$400 million. The impact of KEIIP will be enhanced access to water supply and sanitation in KMC. The outcome will be improved water supply, sewerage, and drainage service quality and operational sustainability in selected areas of KMC. Thus, KEIIP has three outputs: (i) inefficient water supply assets rehabilitated; (ii) sewerage extension along with sewage treatment facilities to peripheral areas continued; and (iii) financial and project management capacity further developed.

3. KMC is KEIIP's executing agency. A program management unit (PMU) created under KMC is implementing KEIIP. The first loan under the MFF, Tranche 1, or Loan 3053-IND, amounting to \$100 million, was approved by ADB on 22 October 2013, signed on 3 March 2014, and made effective on 30 May 2014.

4. Project 1, supported by Tranche1, included subprojects for improvement of infrastructure, operations, and sustainability in sewerage, drainage and water supply in KMC. While Project 2, supported by the Tranche 2, included physical and non-physical investments in water supply and sanitation improvement in KMC. Project 2 is aligned with improved access to

¹ The 1899 Calcutta Municipal Act defined the administrative domain of the municipal authority as covering 25 wards and 48.5 km². Many boundary changes followed, the latest one in January 1984, when Boroughs XI, XII, XIII, XIV, and XV were annexed to KMC. These boroughs are popularly known as the "added areas." Recently, the KMC has been further expanded by including Joka area in the southern part of the city creating 3 additional wards under a new Borough XVI.

²ADB. 2000. Report and Recommendation of the President to the Board of Directors: Proposed Loan to India for the Calcutta Environmental Improvement Project. Manila (Loan 1813-IND, \$250 million, approved on 15 November 2000). The project completion date is 30 June 2012; ADB 2006. Report and Recommendation of the President to the Board of Directors: Proposed Supplementary Loan to India for the Kolkata Environmental Improvement Project. Manila (Loan 2293-IND: \$80 million, approved on 20 November 2006). The project completion date is 30 June 2012.

³ADB provided project preparatory technical assistance. ADB. 2009. Technical Assistance to India for Preparing for Kolkata Environmental Improvement Project II. Manila.

5. water supply and sanitation in KMC, as defined by KEIP. Tranche 2 loan 3413-IND was signed on 21 November 2016 and physical work has already started. Project 3, supported by Tranche 3, includes physical and non-physical investments in sanitation improvement in the KMC area. Tranche 3 loan 3689-IND was signed on 3rd October 2018 and physical work has already started.

6. At present, KEIP Tranche -3 are under implementation. The new subproject “Construction of Sewage Treatment Plant at Rajpur - Sonarpur , Rania STP (23 MLD).” is considered under Tranche 3. The subprojects under tranche 3 of KEIP are listed in table 1 below.

Table 1: Sewerage and Drainage Packages under Tranche 3

Sr. No.	Package Name	Package No.
1	Improvement of S&D Network and construction of a Pumping Station in Alipore Body Guard Line premises in ward 74	SD-27R
2	Construction of Sewage Treatment Plant near WBSETCL, Joka. (45 MLD).	SD-28
3	Construction of Sewage Treatment Plant at Bank Plot, M G Road, Joka (40 MLD).	SD-29
4	Construction of Sewage Treatment Plant at Rajpur - Sonarpur , Rania STP (23 MLD).	SD-30
5	Lot1: Development of S & D Network in Churial Extension PS Catchment & Diamond Park Catchment and Construction of Churial Extension Pumping Station (Annex) in Borough XVI (part of ward 124,143 & 144)	SD-31 Lot-1
5	Development of S&D Network in Bakrahat Road catchment (ward -125) by cut & cover method and Laying of RCC sewer line along Bakrahat road and DH road by micro tunneling method”	SD-31R2
7	Improvement of S&D System in Mukundapur Area (Part of Ward 109) including Construction of Mukundapur Pumping Station(Ward 109)	SD-32
8	Construction of 2 new pumping stations near confluence of Lalababu Nikashi & Bagjola canal and within Behala Node C premises, Sakuntala Park.	SD-34

MLD = million liters per day, RCC = reinforced cement concrete, S&D = sewerage and drainage, STP = sewage treatment plant, WBSETCL = West Bengal State electricity, Transmission Company Limited.

B. Scope of this Report

7. A draft land acquisition and resettlement due diligence report (DDR) was prepared and disclosed for the proposed sewerage and drainage (S&D) subproject SD30R (in 2017-18) that involves the construction work of sewage treatment plant located at Rajpur Sonarpur, Rania, which has been planned to treat the DWF generated from S&D systems in parts of Borough XI and parts of Borough XIII of south Kolkata. This DDR has been updated based on the revised design. KEIP could not obtain the private land required for the package; hence, the project design was modified from 30 MLD STP to 23 MLD STP to accommodate within the allotted 0.96 acres of government land. No Involuntary Resettlement impact has been identified during detailed measurement survey based on final design. During implementation stage regular

monitoring will be done by the social safeguard officer PMU and the findings will be incorporated in the semi-annual social monitoring report.

8. During project implementation, the officer designated for social safeguards at PMU will (i) undertake a review and monitor this due diligence; (ii) update DDR or prepare safeguards document as required if there is a change in project design and scope;; and (iv) report the status in SMR.

I. SUBPROJECTDESCRIPTION

9. The proposed STP serves not only the KMC area but a small part of Sonarpur Rajpur Municipality area as well. The total catchment area for the accumulated dry weather flow of the STP is 616 hectares (ha). The project horizon for this project is 2030, and future expansion for population up to year 2045, a provision for augmentation is also within the project scope. The command area of the STP at Rajpur Sonarpur has a projected population about 166153 for the year 2030, and average design is about 23 million liters per day (MLD) and for the year 2030, The command area of the proposed STP covers the part of ward No 111,112,113,114, 115, and 142 also a part of Sonarpur Rajpur municipality comprising an area of 69 ha. The population projection and calculation for design flow is appended in Table 2.

Table 2: Planned Plant Capacity for Sewage Treatment Plant at Rajpur Sonarpur

Year	Population	Planned Capacity (MLD)
2015	123962	18
2030	166153	23
2045	220450	30

10. The basic design criteria for the STP is total quantity of the influent, in this case the total flow for this STP is conceptualized as 23 MLD for 2030. The other basic design criteria for the STP is the characteristics of the influent water like biochemical oxygen demand (BOD), total suspended solid, total nitrogen, total phosphate and the design purpose the design temperature or the operating temperature for the STP is stated at table below.

Table 3: Influent Characteristics for Sewage Treatment Plant at Rajpur Sonarpur Municipality

Criteria Name	Description	Unit
Design capacity	23	MLD
Influent BOD ₅	200	mg/l
Influent COD	350	mg/l
Influent SS	375	mg/l
Influent TN	45	mg/l
Influent TP	5	mg/l
Fecal Coliform	1 x 10 ⁶	MPN/100 ml

mg/l = milligram per liter.

Source: Municipal Raw Sewage Characteristics as per CPHEEO manual for Indian cities.

11. The projects cover parts of wards 111,112,113 and 114 of Borough XI, Ward 115 of Borough XIII and parts of ward 142 of Borough XVI of KMC. In addition to that some adjoining areas of Rajpur Sonarpur municipality are also included in the command area

12. Since the STP is located there. The population of the catchment for the design horizon (2030) is 166,153 and its total catchment is approximately 617 ha, which will serve as the command area for the proposed STP.

13. The command area is bound by Keorapukur Canal in the west and extends towards east with KMC south boundary in wards 142, 114, 113, 112 and 111. The command area is relatively flat with Western Canal passing through it. The command area extends till east of Risi Raj Narayan Road south in ward 111. The northern and western part of the command area adjoining Rania Canal is relatively more densely populated. Currently it does not have organized S&D system or any sewage treatment plant serving it.

14. The site of the proposed STP itself is located off the Rania Road in Rajpur Sonarpur Municipality.

15. The following is the rationale for taking up this project:

- (i) To ensure that the command area has a fully functioning S&D network of which STP is a crucial component;
- (ii) To improve public health, for population living on the banks of the canals as well as areas around it; and
- (iii) To improve water quality of River Ganga by treating waste water before discharging for fulfilling Government Policy and one of the objectives of cleaning river Ganga.

16. Based on the objective and need of the subproject, the following scope of work is proposed, including all the required activities to make the STP functional.

- (i) Design and construction of STP
- (ii) Laying of DWF pumping main from Battery Limit as shown in the drawing to STP (Approx. 300m)
- (iii) Laying of effluent discharge line to Rania Canal (Length Approx. 300 m)
- (iv) Construction of Covered Surface drain of internal Size 1 m x1m
- (v) Project facilities for the STP including storm water drainage, lighting, plantation of trees/greenbelt.

II. FIELD WORK AND PUBLIC CONSULTATION

A. Outline of Field Work

17. In November 2020, field inspections were carried out at the proposed sub -project site location for sewerage and drainage subproject and its adjoining areas. Stakeholder consultations were also conducted. Inspections and transect walks were carried out in the sub project areas.

B. Public Consultation

18. Consultations were undertaken with key stakeholders in line with ADB's requirements pertaining to environmental and social considerations. The tool used for consultation was stakeholder meetings. These consultations helped to identify the felt needs/concerns and apprehensions of the communities related to the project and priorities of concerned stakeholders. Discussions were held with people residing at/near and/or having businesses at/near the proposed subproject locations. The community people are willing to cooperate for

the proposed project. The local community people willingly cooperated for the construction of the sub-project which they understand is for their own betterment and better civic facilities. Summary of stakeholder consultation is provided in Table 4 and the stakeholder consultations report and list of participants is provided in Appendix2.

Table 4: Summary of Community Consultation

Date	Location	Number of Participants	Participant Details	Key Discussions
30 June 2017	Rajpur Sonarpur Municipality	15	Local residents, shop owners, housewives, businessmen, Service men, representatives of KEIP and Contractors	<ul style="list-style-type: none"> (i) Suitable wastewater treatment technology will be selected adhering to latest discharge norms by CPCB; (ii) It will be ensured that the technology selected can be executed within the land area available for treating the command area's dry weather flow (DWF); (iii) The subproject will provide a wastewater discharge in the Rania Canal which will ensure amelioration of its water quality; (iv) The project work will reduce environmental impact/ health problems that is caused by open discharge of domestic waste water; and (v) It will be ensured that river Ganga is not polluted which is a priority of the state and national government.
November 2020	Door to door consultation was carried out (instead of group gathering)	35	Local residents, shop owners, housewives, businessmen,	<ul style="list-style-type: none"> (i) Objective of the project. (ii) Proposed components (iii) Existing water logging during heavy showers, backflow of water from adjoining area happens to be a persistent issue. (iv) Choking of drains, latrines etc. during heavy showers. (v) Grievance redress mechanism and its procedure

III. LAND AVAILABILITY

19. The proposed construction work will be done on land parcels owned by Government of West Bengal. The 1.13 acres of land out of which 0.96 acres will be used for construction work, schedule of which is given as Mouza - Rania, J.L. No. 62, Dag No. – LR 237, P.S. - Sonarpur, Dist-South 24 Parganas is vested area in Appendix 3.

20. The details of land are appended below:

Table 5: Details of Proposed Land of Rania

District	Mouza	J.L. No.	R.S. Plot No.	Full / Part	Plot Area Available (acres)	Area required for construction (acres)
Dist. - South 24 Parganas	Rania	62	237	Full	1.13	0.96

21. Construction work in the subproject area has been carefully planned to minimize any disturbance to adjacent community people and pedestrians (if any). The proposed site is a vacant plot and assessed to have no resettlement impact. In the command area of the proposed STP, development of the trunk S&D network for the part of the areas has been considered under Tranche 2. The network will collect the dry weather flow (DWF) at the Vivekananda pumping station. The DWF collected will be then pumped to the proposed STP for treatment.

22. Laying of pumping mains for carrying DWF from Vivekananda Pumping Station to STP and effluent discharge from STP to Rania Canal will be through open cut method. The effluent discharge pipeline will be laid through Rania Road to Rania Canal. The following Table 6 provides details of the pipelines to be laid.

Table 6: Details of Dry Weather Flow Pipelines and Effluent Discharge Pipelines

Component	Length of Pipeline (m)	Dia of Pipe (mm)	Road Width (m)	Trench Width (m)	Land Ownership
Laying of pipeline for carrying DWF from to STP	300	700	4 m wide road	1.5	Rajpur Sonarpur Municipality
Laying of Effluent Discharge Pipeline from STP to Rania Canal	300	600	4 m wide road	1.3	Rajpur Sonarpur Municipality

DWF = dry weather flow, m = meter, mm = millimeter, STP = sewage treatment plant.

Figure 1: Google Earth Map of Subproject Area



IV. CONCLUSION

A. Summary and Conclusion

23. The execution of proposed civil works under the subproject will not trigger any involuntary resettlement impacts. The identified sites for the proposed civil works at all pipe laying zones is proposed along government road rights of way. Temporary disruptions in traffic movement during construction will be mitigated by the contractor through a traffic management plan and simple measures such as proper stacking/storing of construction materials, provision of planks to ensure that pedestrian access to residences is maintained. This DDR has been updated based on revised design. The DDR will be further updated with all land related documents and no objection certificates.

PHOTO GALLERY - JIADAGOTE SEWAGE TREATMENT PLANT



Pipe Alignment for Influent line from Vivekananda Road PS



Community Consultation at Rajpur Sonarpur Sewage Treatment Plant Plot

Photographs of Field Level Consultations and Distribution of Project Information Leaf let





Appendix 1: Participants List of Community Consultation

KOLKATA ENVIRONMENTAL IMPROVEMENT INVESTMENT PROGRAMME		
List Of Participants In Community Consultation		
Date:	30.6.17.	Place:
Sl. No.	Name	Signature
1.	সোহনমাত্ম বিজ্ঞান	S.B
2.	সাদবির- স্মরণীমা	G.S.
3.	সুগমাত্ম সান্ড	
4.	Sowma Gupta	Sauf
5.	Sandipan Koley	S. K.
6.	গোরি দাস	G.D.
7.	অভয় গুপ্ত	Abhay Das
8.	ইন্দ্রনীল ভদ্র	Indranil Bhadra
9.	সোমেন্দ্র মিত্র	G. Mitra
10.	সফিন্দ্র রাজরা	S. Hazra
11.	সাদব গুপ্ত	J. Ghosh
12.	ব্রজেন কব	B.K.
13.	সমীক দেবদাস	S.M.
14.	সমর দাস	S.M.
15.	সমর সান্ডিগা	S.M.

Appendix 2: Details of Proposed Land of Rania

District	Mouza	J.L. No.	R.S. Plot No.	Full / Part	Plot Area Available (acres)	Area required for construction (acres)	Land Ownership	Present Land use pattern & IR Impact
Dist. - South 24 Parganas	Rania	62	237	Full	1.13	0.96	Govt. of West Bengal	Unused vacant plot and no IR Impact

Appendix 3: Request letter for transfer/hand over of vested land to Kolkata Municipal Corporation for development work

<p><i>Khalil Ahmed, I. A. S.</i> Municipal Commissioner</p>		<p>The Kolkata Municipal Corporation Central Municipal Office 5, S.N. Banerjee Road Kolkata-700 013 Phone- 2286-1234 Fax- 2286-1334 Date: 02.12.2016</p>
<p>No. Con / Com / 514 /2016-17</p>		
<p>To The Secretary, Municipal Affairs Department Govt. of West Bengal Poura Prashasan Bhawan, DD-1, Sector-1, Salt Lake City, Kolkata- 700 064</p>		
<p>Subject:- Transfer / hand over of vested land to KMC for development project</p>		
<p>Sir, This is to inform that Plot No. 237 of Mouza- Rania, J.L. No. 62, P.S. – Sonarpur measuring area of 1.19 acres is reported by the B.L.& L.R.O, Sonarpur as vested to the state. Pursuant to decision taken in the meeting with the Hon'ble Mayor, said plot of land has been inspected on 01.12.2016 by a team of officials of KMC, KEIIP, Engineering Cell of KEIIP, in presence of the B.L.&L.R.O, Councillor of 35 Ward of Sonarpur- Rajpur Municipality. The said land has been selected for construction of a water treatment plant/ drainage pumping station etc. which is urgently required for the project.</p>		
<p>You are requested to kindly arrange for transfer / hand over the said land to KMC at the earliest for its use for the purpose mentioned above. Pending formalities possession of the said plot of land be given immediately.</p>		
<p>This may kindly be treated as most urgent.</p>		
<p>Thanking you.</p>		
<p>Yours faithfully,</p>		
<p><i>Khalil Ahmed, I. A. S.</i> Municipal Commissioner</p>		
		
<p>Encl: As stated</p>		
<p>No. Con / Com / 514 /2016-17</p>		
<p>Dated 02.12.2016</p>		
<p>Copy to :</p>		
<ol style="list-style-type: none"> 1. The Land Reforms Commissioner and Principal Secretary to the Govt. of West Bengal, Nabanna, 325, Sarat Chatterjee Road, Howrah – 711 102 for kind information and necessary action 2. the District Magistrate & Collector, South 24-Parganas. 3. The Addl. District Magistrate and District Land & land Reforms Officer, South 24-Parganas for information and necessary action. 4. The Project Director, KEIIP for follow up action 5. O.S.D. to the Hon'ble Mayor 		
<p><i>Khalil Ahmed, I. A. S.</i> Municipal Commissioner</p>		

Appendix 4: Land Transfer process order copy from Office of the Block Land and Land Reforms Officer (BLRO) (Writ of Possession)

GOVERNMENT OF WEST BENGAL
OFFICE OF THE BLOCK LAND AND LAND REFORMS OFFICER
SONARPUR, 24 Parganas(s)
WRIT OF POSSESSION

In pursuance of order of Assistant Secretary to the Government of West Bengal, communicated to this end being no. XVIII/3119/1/LR-SNP01/17 dated 25/7/17 from the end of A.D.M. & D.L.&L.R.O., South 24 Parganas, the undersigned do hereby make over the possession of the following schedule of land on 30/08/2019 at 11.30a.m. being authorized by competent authority in this regard. The said land has been proposed for Inter Departmental Transfer of Govt. lands in favour of the Urban Development and Municipal Affairs Department, Govt. of West Bengal.

Land schedule

Police station- Sonarpur
Mouza- Rania
J.L.NO.—62
Dag no.- L.R., 237.
Area - 1.13 acre.

Soma Ganguly
Signature of the officer making
Block Land and Land Reforms Officer
Sonarpur, South 24 Parganas
(Designation- B.L.&L.R.O., Sonarpur)

Phalke
Signature of the officer taking
over possession
ASSL. Engineer (Civil)
Ch. V & S Dept.
(Designation- Assistant Engineer Civil,
Ch. V. & S. Department)

Signature of witnesses-
1. *Alom Choudhury* D.L.
2. *Sujata Samanta* A.O.

3. *Subal Choudhury* name
4. *Sukuman Bena*, Land Officer, KEIP
30/08/19
date - 30/08/2019

Memo no.- 1625 /BLR-SNP/17

Copy for information to-

1. A.D.M. & D.L.&L.R.O., 24 Parganas (s) for the sake of his kind perusal.

2) Copy to Chief Valuer & Surveyor, KMC as this has a reference to your letter being no. Ch. V & S /212/2019-20 dt - 27/8/19.

B.L.&L.R.O., Sonarpur
30/8/19

The Captioned Schedule of Land duly demarcated has been handed over to the representative of KEIP, KMC on 30.08.2019.

Handed over by
Phalke, A.E.C.I.
Witness:- *Subal Choudhury*

Possession taken over by
Sukuman Bena, Land Officer, KEIP
30/08/19

Sketch Map of proposed Land for Rajpur Sonarpur STP

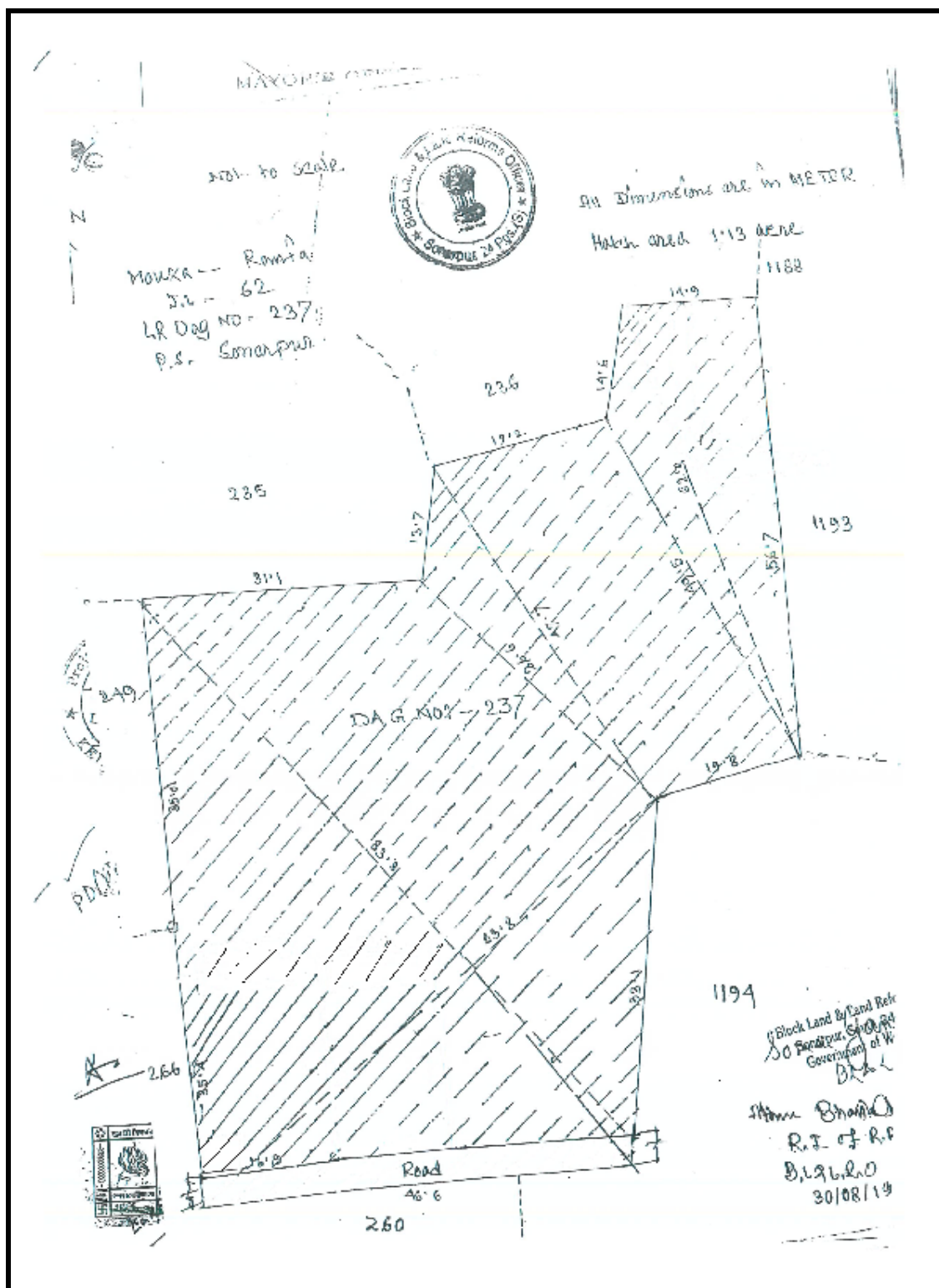

Appendix 5: No objection certificate from Rajpur - Sonarpur Municipality

Phone No. : 2477 9245

RAJPUR-SONARPUR MUNICIPALITY
VILL & P.O-HARINAVI, SOUTH 24-PARGANAS

Ref no. 62 R. S. M. 16. Date. 15.01.16.

To
Shri Soumya Ganguly,
Director General (Project),
Kolkata Environmental Improvement Investment Program,
206, A.J.C. Bose Road, Kolkata - 700 017.

Sub: Approval of laying of Trunk Sewer in Rajpur-Sonarpur Municipality along Rania Main Road, Rania Ramkrishna Sarani and Rania Vidyasagar Sarani, Wards Nos. 34 and 35 under Kolkata Environmental Improvement Investment Program (KEIIP).

Ref.: Your Letter No. PMU/573/2015-16 , dated 04.01.2016.

Sir,

With reference to your above mentioned letter and subsequent discussion at my Chamber on 06/01/2016, I am on behalf of this Municipality glad to inform you that your proposal is being accepted and you may go forward with the project.

You are requested to intimate this office after finalization of this project and before commencement of work.

Thanking you,

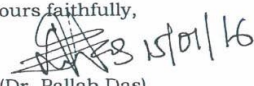
Yours faithfully,

(Dr. Pallab Das)
Chairman
Rajpur-Sonarpur Municipality

PG/db/PWD/L-80(1)